

Appendix 1
Cross Section

Proposed dwelling - The Pines - 11 Wetncky Road - Kearsnough
for Mr + Mrs E. O'Grady.

HARROGATE BOROUGH COUNCIL
PLANNING DIVISION
REC'D 16 JUN 2005
APP NO. C/100 131 Falls

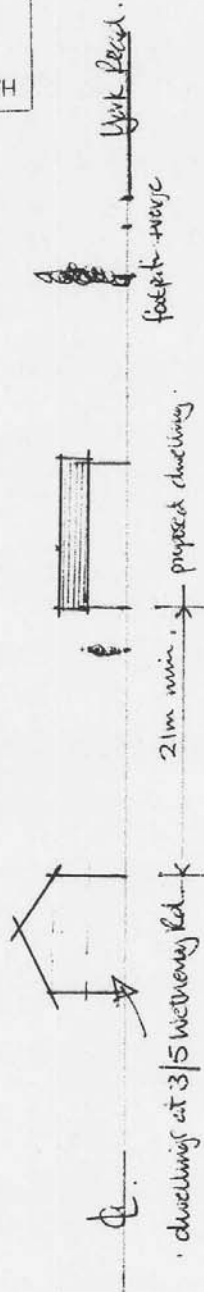

23

Cross Section through site showing Wetncky Road houses /
proposed dwelling

Scale 1:500.

Ref. YR/3/05 March 05.

Appendix 2
Previous refusal

DO NOT COPY

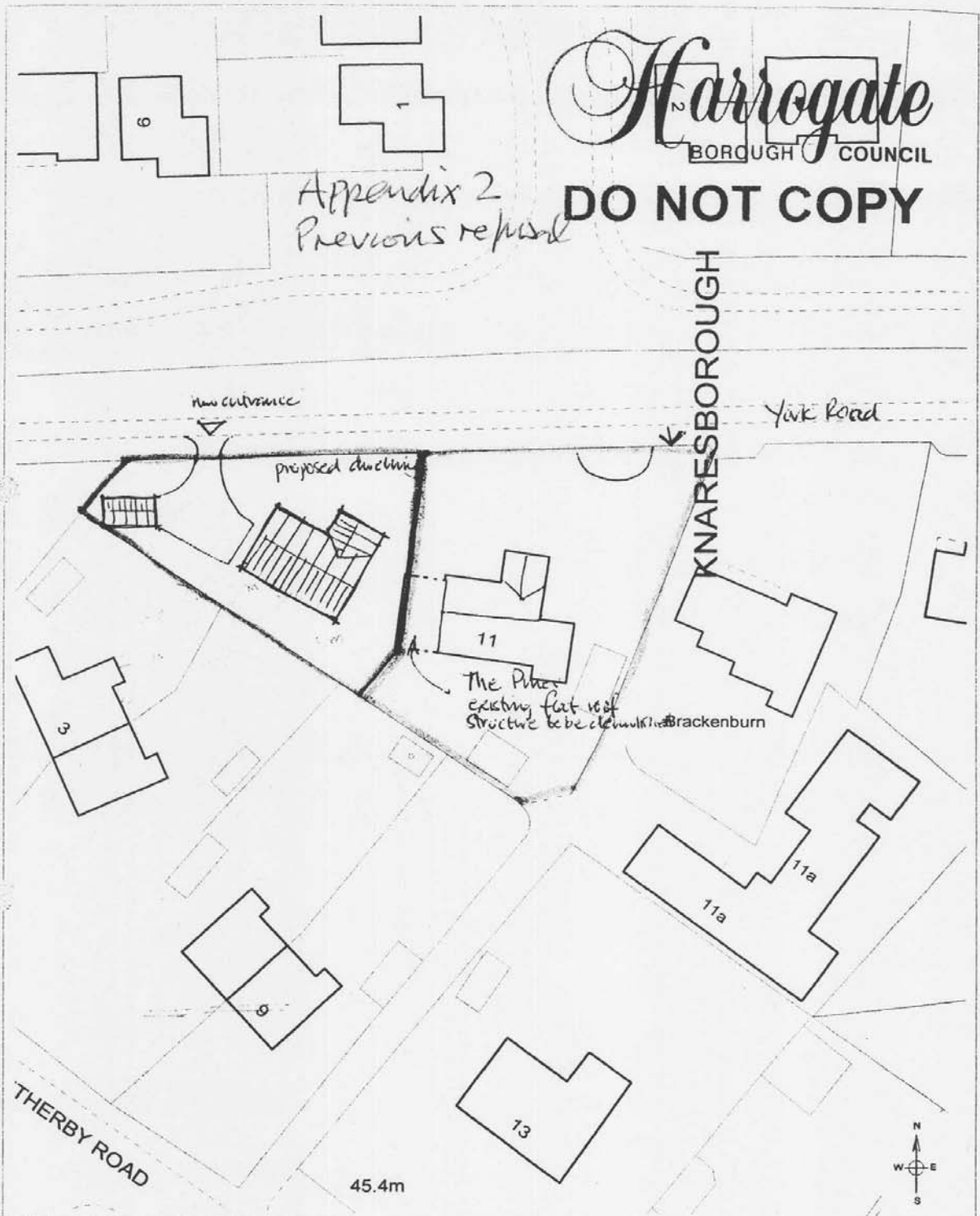

Location
11 Wetherby Road, Knaresborough

Grid Ref. 435971/456728

1:500
BY: IPPU
14th October 2004

DEPARTMENT OF TECHNICAL SERVICES

29

This copy has been produced specifically for Map Return Scheme purposes only. No further copies may be made.

This map is reproduced from Ordnance Survey material with the permission of Ordnance Survey on behalf of the Controller of Her Majesty's Stationery Office. © Crown copyright. Unauthorised reproduction infringes Crown copyright and may lead to prosecution or civil proceedings. (Harrogate Borough Council 100019628 - 2004)

HARROGATE BOROUGH COUNCIL
 PLANNING DIVISION

REC'D 16 JUN 2005

APP NO 3105 TR F20

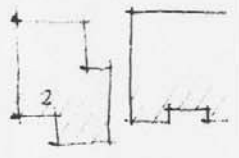

Appendix 3
 Revised Current Application

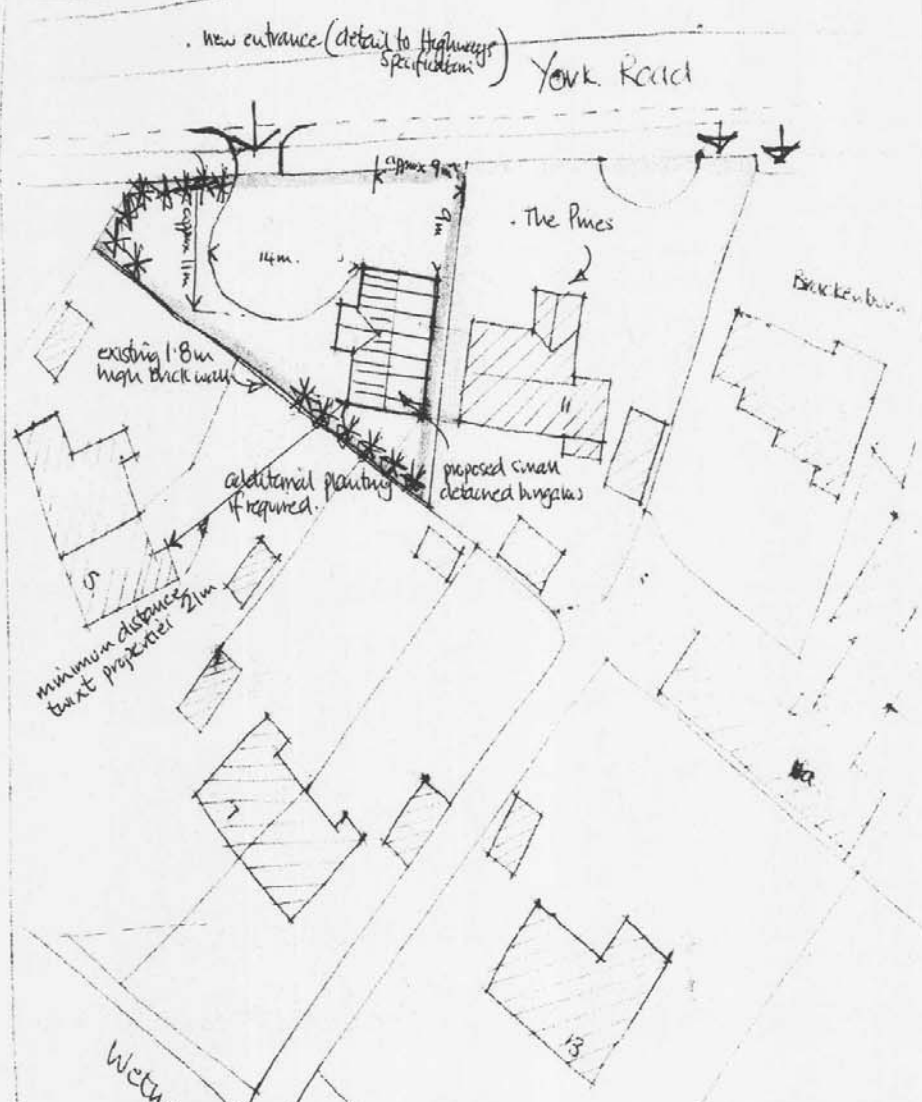

Scale 1:500. Site Plan.

Rev A parking/turning dimensions indicated. 23/5/05.

Ref YR/2/05 rev A.

Proposed detached bungalow at
 The Pines 11 Wetherby Road.
 Knaresborough.

